



# W 61807-2RS1 Deep groove ball bearings

## Deep groove ball bearings

### Bearing data

[Tolerances](#),

Normal (metric), P6, P5, Normal (inch),

[Radial internal clearance](#),

Matched bearing pairs, Stainless steel  
 $d < 10$  mm, Other bearings

### Bearing interfaces

[Seat tolerances for standard conditions](#),

[Tolerances and resultant fits](#)

## Technical specification

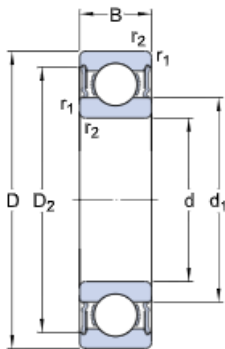

### DIMENSIONS

d	35 mm	Bore diameter
D	47 mm	Outside diameter
B	7 mm	Width
$d_1$	≈ 38.21 mm	Shoulder diameter
$d_2$	≈ 38.21 mm	Recess diameter
$D_2$	≈ 43.69 mm	Recess diameter
$r_{1,2}$	min. 0.3 mm	Chamfer dimension

### ABUTMENT DIMENSIONS

$d_{\varepsilon}$ min.	37 mm	Diameter of shaft abutment
$d_{\varepsilon}$ max.	38 mm	Diameter of shaft abutment
$D_i$ max.	45 mm	Diameter of housing abutment
$r_a$ max.	0.3 mm	Radius of shaft or housing fillet

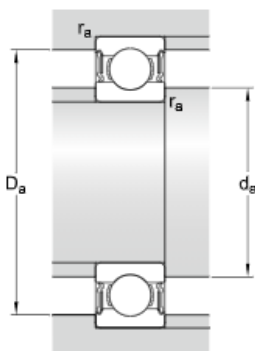

## CALCULATION DATA

C	3.71 kN	Basic dynamic load rating
C <sub>0</sub>	3.35 kN	Basic static load rating
P <sub>u</sub>	0.14 kN	Fatigue load limit
	8 500 r/min	Limiting speed
k <sub>r</sub>	0.02	Minimum load factor
f <sub>0</sub>	14.3	Calculation factor

## MASS

	0.03 kg	Mass bearing
--	---------	--------------

## TOLERANCE CLASS

Normal	Dimensional tolerances
Normal	Radial run-out